

# SIMA

MANAGEMENT  
CORPORATION

## FOR LEASE

THE LOCAL LEADER IN  
EXTRAORDINARY PROPERTIES

506-508 STATE STREET

HAWLEY BUILDING • 1231 - B STATE STREET, SANTA BARBARA, CA 93101 • 805.965.1616 • [WWW.SIMA.NET](http://WWW.SIMA.NET)





ADAM GEEB  
Adam.Geeb@sima.net  
Ext. 213  
DRE# 01445473

CARLY BARNES  
Carly.Barnes@sima.net  
Ext. 208  
DRE# 01730439

## LEASING SUMMARY

**Type:** RESTAURANT/RETAIL

**Size:** 1,347 / 2,202/ 3,549 RSF

**Lease Rate:** \$3.95/SF + NNN

**Term:** Negotiable

**Parking:** Adjacent to City Lot

\*From 1,347 sf (506), 2,202 sf (508), up to 3,549 RSF of contiguous indoor space available plus opportunity for ample outdoor patio seating on both sidewalk and the Downtown Promenade.

## DESCRIPTION

This premier restaurant/retail space occupies a prime location downtown in the heart of the business and retail districts on the corner of State and Haley Streets. The space is located within close proximity to popular restaurants, shopping and cafes, and is within walking distance to the Funk Zone, the Moxi Children's Museum and lower State Street. These spaces feature high ceilings, natural light, HVAC, multiple restrooms and plentiful State Street frontage including access to additional sidewalk and parklet seating. This is a great opportunity to lease both spaces together, or can be leased separately.

## RESTAURANT/RETAIL AVAILABLE



**506 - 508 STATE STREET**





ADAM GEEB  
Adam.Geeb@simanet  
Ext. 213  
DRE# 01445473

CARLY BARNES  
Carly.Barnes@simanet  
Ext. 208  
DRE# 01730439

## RESTAURANT/RETAIL SPACE FOR LEASE IN SANTA BARBARA, CA

### 506-508 STATE STREET

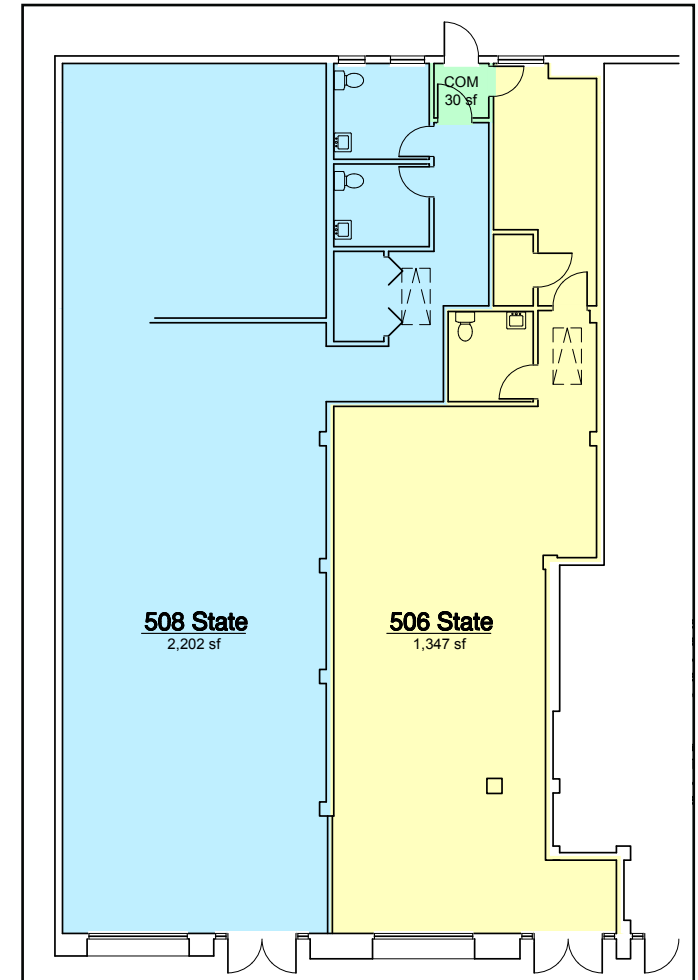





ADAM GEEB  
Adam.Geeb@sima.net  
Ext. 213  
DRE# 01445473

CARLY BARNES  
Carly.Barnes@sima.net  
Ext. 208  
DRE# 01730439

## RESTAURANT/RETAIL SPACE FOR LEASE IN DOWNTOWN SANTA BARBARA

