



FOR LEASE

THE LOCAL LEADER IN
EXTRAORDINARY PROPERTIES



710 STATE STREET



ADAM GEEB
 Adam.Geeb@sima.net
 Ext. 213
 DRE# 01445473

CARLY BARNES
 Carly.Barnes@sima.net
 Ext. 208
 DRE# 01730439

LEASING SUMMARY

- Lease Rate:** \$3.75/s.f. + NNN
- Term:** 3-5 years
- Size:** 8,812 s.f.
- Parking:** reserved + city parking
- Available:** Summer 2024

DESCRIPTION:

This premier retail space occupies a prime location downtown in the heart of the business and retail districts. The space is located within close proximity to popular restaurants, breweries, shopping and cafes, is across the street from the Paseo Nuevo shopping center, and within walking distance to the Funk Zone, the Presidio Neighborhood, the Moxi Children’s Museum and the newly developed La Entrada. This fully turn-key retail space has high ceilings, natural light through large windows and skylights, HVAC, private restrooms, a spacious rear area for office or storage and 50+ feet of State Street frontage. A rear entrance/exit provides easy access to a reserved private parking lot and deliveries. The property’s nearby co-tenants include Blenders in the Grass, Banana Republic, McConnel’s Fine Ice Creams, and Lululemon Athletica, among many others.

DOWNTOWN RETAIL AVAILABLE

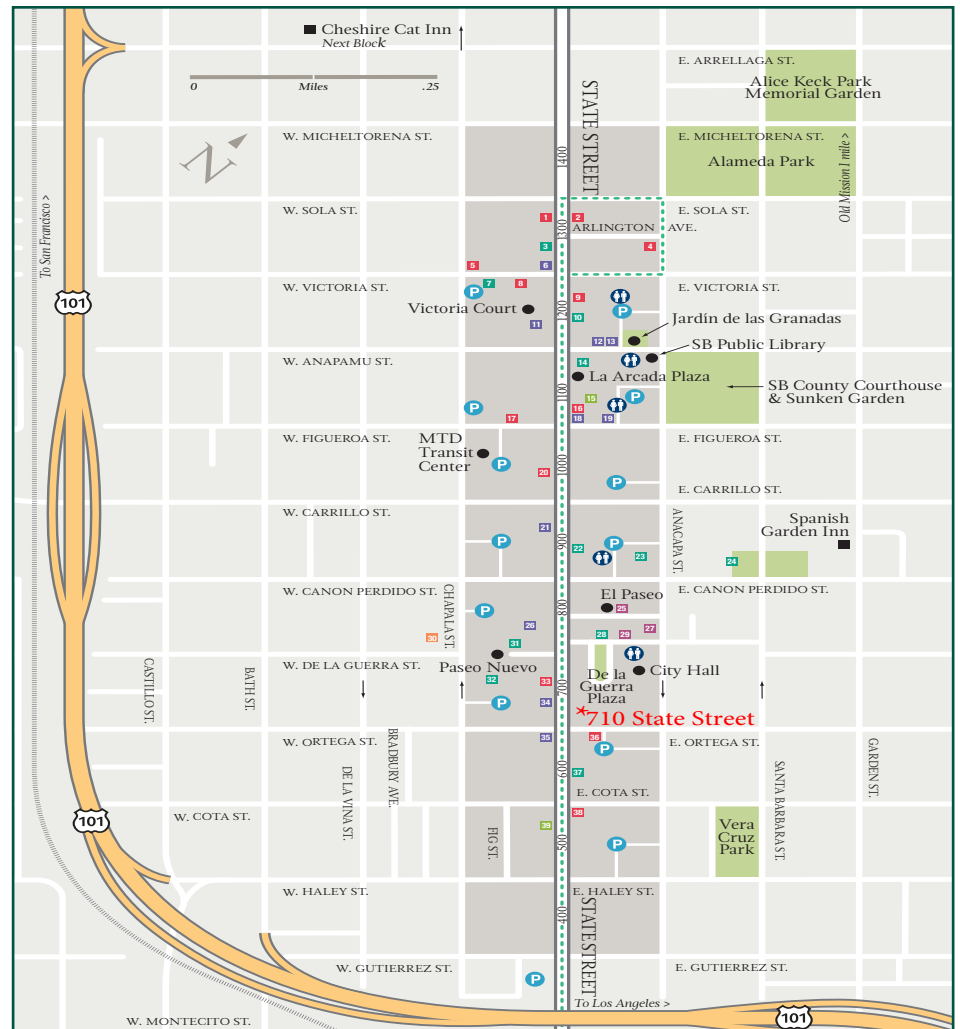

710 STATE STREET



ADAM GEEB
Adam.Geeb@sima.net
Ext. 213
DRE# 01445473

CARLY BARNES
Carly.Barnes@sima.net
Ext. 208
DRE# 01730439

RETAIL SPACE
DOWNTOWN SANTA BARBARA

710 STATE STREET

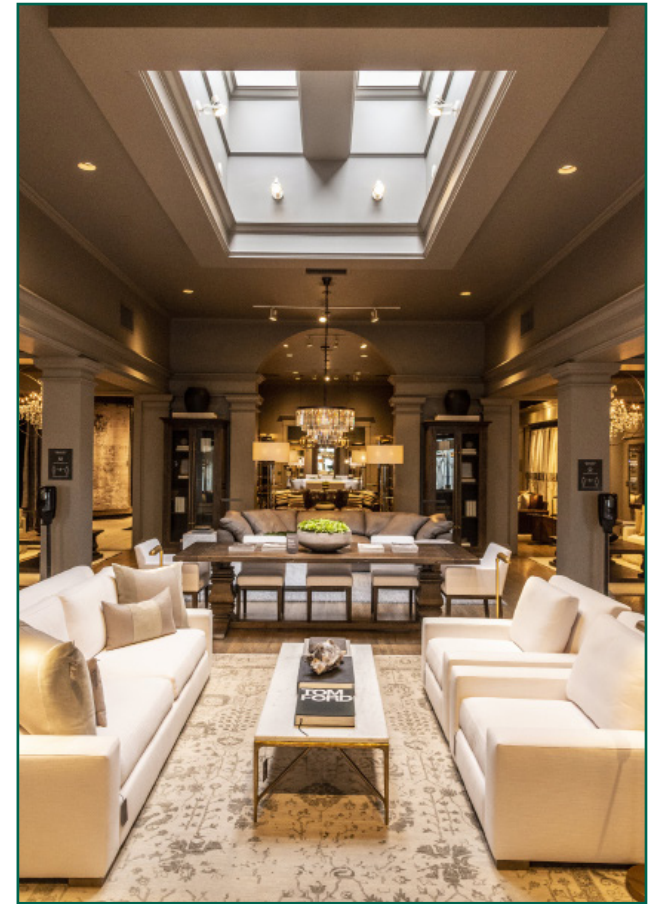



ADAM GEEB
Adam.Geeb@sima.net
Ext. 213
DRE# 01445473

CARLY BARNES
Carly.Barnes@sima.net
Ext. 208
DRE# 01730439

RETAIL SPACE DOWNTOWN SANTA BARBARA

710 STATE STREET

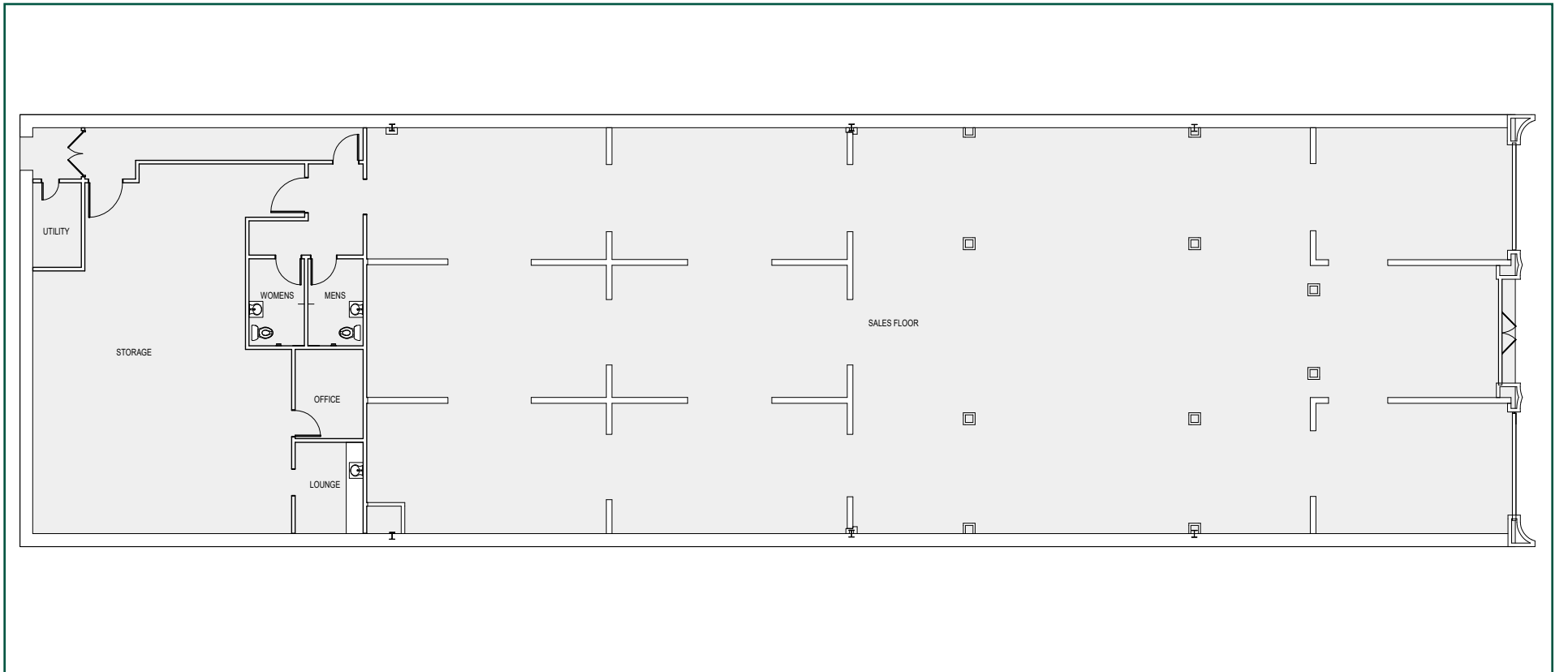



ADAM GEEB
Adam.Geeb@sima.net
Ext. 213
DRE# 01445473

CARLY BARNES
Carly.Barnes@sima.net
Ext. 208
DRE# 01730439

RETAIL FOR LEASE DOWNTOWN SANTA BARBARA

710 STATE STREET

