



SIMA

MANAGEMENT
CORPORATION

FOR LEASE

THE LOCAL LEADER IN
EXTRAORDINARY PROPERTIES

1109 STATE STREET

HAWLEY BUILDING • 1231 - B STATE STREET, SANTA BARBARA, CA 93101 • 805.965.1616 • WWW.SIMA.NET



ADAM GEEB
Adam.Geeb@simanet
Ext. 1213
DRE# 01445473

CARLY BARNES
Carly.Barnes@simanet
Ext. 1208
DRE# 01730439

DOWNTOWN RETAIL AVAILABLE

LEASING SUMMARY

Lease Rate: \$2.50/SF + NNN

Term: Negotiable

Size: 15,701 SF (ground level)
5,322 SF & 4,077 SF (2nd & 3rd floors)
2,353 SF (basement)

Total SF Available: Up to 27,731* SF (*divisible)

Parking: Adjacent City Lot - first 75 min free

Available: March 2026

DESCRIPTION:

This premier retail space occupies a prime location downtown in the heart of the business and retail districts. The space is located within close proximity to popular restaurants, breweries, shopping and cafes, is across the street from the Santa Barbara Museum of Art and in close proximity to the Granada Theatre, the Santa Barbara Courthouse and Arlington Theater. This four level commercial space can be leased entirely or is divisible as small as 15,000 square feet. A rear entrance/exit featuring two roll up doors provides easy access to the City parking lot and deliveries. The property's nearby co-tenants include Anthropologie, CorePower Yoga, Paper Source, Old Navy and Free People.



1109 STATE STREET



ADAM GEEB
Adam.Geeb@sima.net
Ext. 1213
DRE# 01445473

CARLY BARNES
Carly.Barnes@sima.net
Ext. 1208
DRE# 01730439

RETAIL SPACE DOWNTOWN SANTA BARBARA

1109 STATE STREET





ADAM GEEB
Adam.Geeb@sima.net
Ext. 1213
DRE# 01445473

CARLY BARNES
Carly.Barnes@sima.net
Ext. 1208
DRE# 01730439

RETAIL SPACE DOWNTOWN SANTA BARBARA

1109 STATE STREET

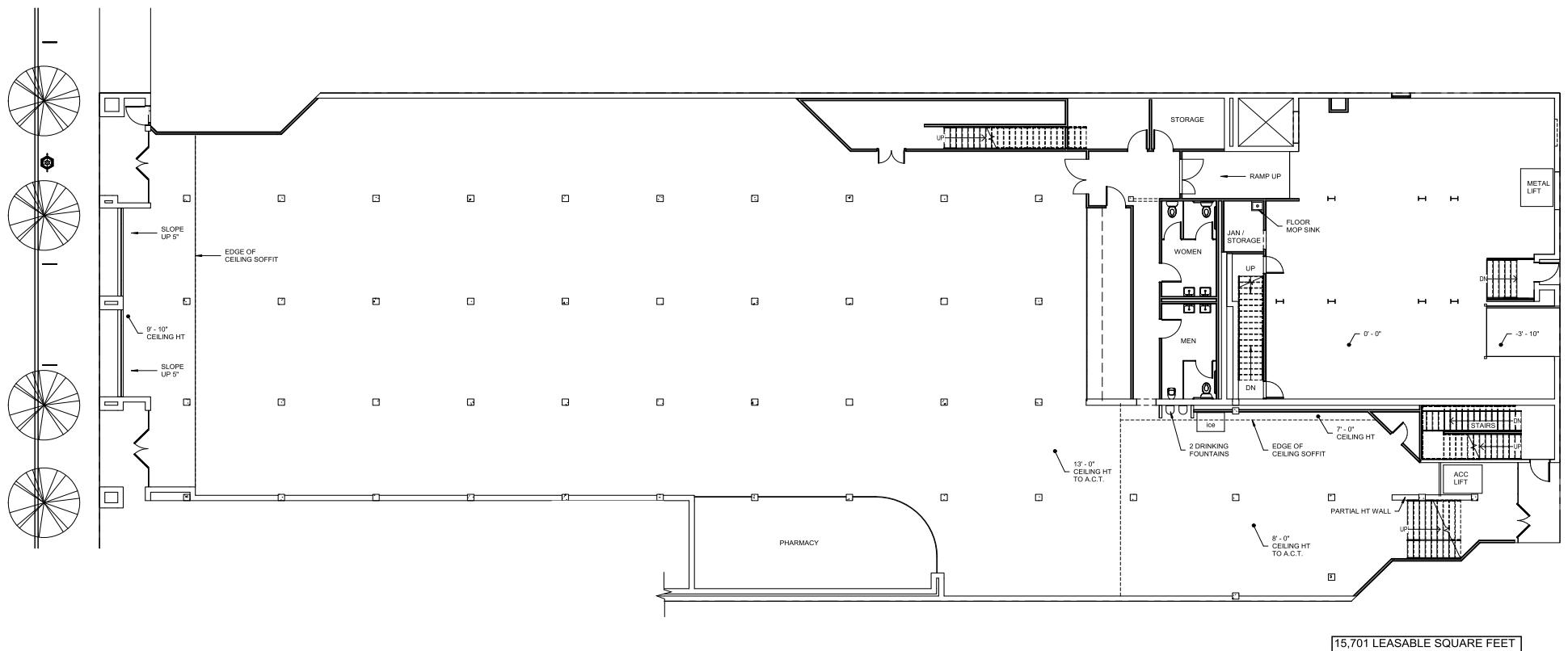

PARKING



ADAM GEEB
Adam.Geeb@sima.net
Ext. 1213
DRE# 01445473

CARLY BARNES
Carly.Barnes@sima.net
Ext. 1208
DRE# 01730439

RETAIL FOR LEASE DOWNTOWN SANTA BARBARA

1109 STATE STREET

